

SPARE PARTS SECTION

COLD SAW

Model. CS-275A

Order Code S822

Edition No : CS-275A-1

Date of Issue : 04/2021

The following section covers the spare parts diagrams and lists that were current at the time this manual was originally printed. Due to continuous improvements of the machine, changes may be made at any time without notification.

HOW TO ORDER SPARE PARTS

1. Have your machines **model number, serial number & date of manufacture** on hand, these can be found on the specification plate mounted on the machine
2. A scanned copy of your parts list/diagram with required spare part/s identified
3. Go to www.machineryhouse.com.au/contactus and fill out the inquiry form attaching a copy of scanned parts list.

CONTENTS

Spare Parts Diagram.....	24
Spare Parts List.....	25
Wiring Diagram.....	27
Wiring Spare Parts List.....	22

SPARE PARTS DIAGRAM

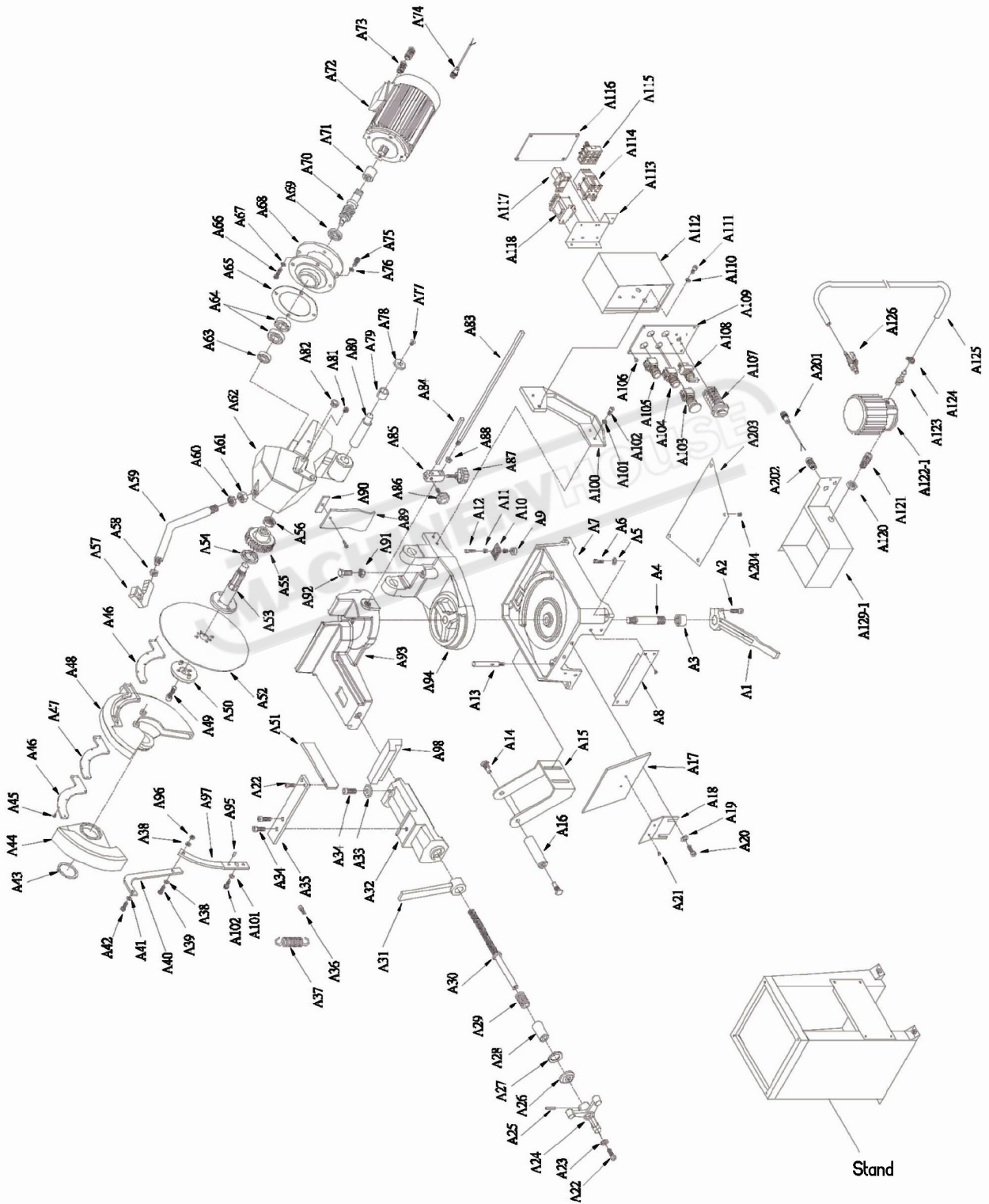

OPERATION MANUAL

SPARE PARTS LIST

ITEM	DESCRIPTION	SIZE	QTY	ITEM	DESCRIPTION	SIZE	QTY
A1	LOCK HANDLE		1	A41	WASHER	1/4"	1
A2	HEX SOCKET CAP SCREW	M10X30	1	A42	HEX SOCKET CAP SCREW	M6X12	1
A3	LOCK NUT		1	A43	C-CLIP	S60	1
A4	SHAFT		1	A44	BLADE SHIELD		1
A5	SPRING WASHER	5/16"	4	A45	SCREW	M5X10	7
A6	HEX SOCKET CAP SCREW	M8X35	4	A46	PLATE		2
A7	MACHINE BASE		1	A47	RUBBER SHEET		2
A8	PLATE		1	A48	BLADE COVER		1
A9	COUNTER WEIGHT		1	A49	HEX SOCKET CAP SCREW	M12X35	1
A10	FILTER NET		1	A50	FIXING FLANGE		1
A11	NUT		2	A51	STOPPER		1
A12	HEX SOCKET CAP SCREW	M8X25	1	A52	SAW BLADE		1
A13	SUPPORT ROD		1	A53	SPINDLE SHAFT		1
A14	ROLLER SHAFT		2	A54	OIL SEAL	35X47X8	1
A15	ROLLER BRACKET		1	A55	WORM GEAR		1
A16	ROLLER		1	A56	LOCK NUT		1
A17	PLATE		1	A57	TRIGGER SWITCH WITH HANDLE		1
A18	PLATE		1	A58	NUT	M10	1
A19	WASHER	5/16"	2	A59	CONTROL HANDLE ROD		1
A20	HEX SOCKET CAP SCREW	M8X16	2	A60	NUT	M20	1
A21	SCREW	M5	2	A61	NUT	M20	1
A22	HEX SOCKET CAP SCREW	M8X20	3	A62	MACHINE HEAD		1
A23	WASHER	5/16"	1	A63	BALL BEARING	6205ZZ	1
A24	HANDLE WHEEL		1	A64	BALL BEARING	6301ZZ	2
A25	PIN	5X40	1	A65	RUBBER SHEET		1
A26	BEARING COVER		1	A66	HEX CAP SCREW	M8X20	4
A27	THRUST BEARING		1	A67	WASHER	5/16"	4
A28	BUSHING		1	A68	FLANGE		1
A29	SPRING		1	A69	OIL SEAL	25X45X10	1
A30	LEADING SCREW		1	A70	WORM SHAFT		1
A31	LOCK HANDLE		1	A71	COUPLING		1
A32	SLIDING VISE		1	A72	MOTOR 1HP		1
A33	WASHER		1	A73	WIRE TERMINAL CLAMP		2
A34	HEX SOCKET CAP SCREW		2	A74	CONTROL WIRE		1
A35	PLATE		1	A75	HEX CAP SCREW	M8X20	4
A36	SCREW	M10X30	1	A76	WASHER	5/16"	4
A37	SPRING		1	A77	SCREW	M8	2
A38	WASHER	1/4"	2	A78	COVER		2
A39	HEX SOCKET CAP SCREW	M6X25	1	A79	BUSHING		1
A40	SWITCHING HANDLE		1	A80	SHAFT		1

NOTE: SOME INDIVIDUAL PARTS MAY ONLY BE AVAILABLE AS AN ASSEMBLY

SPARE PARTS LIST

ITEM	DESCRIPTION	SIZE	QTY	ITEM	DESCRIPTION	SIZE	QTY
A81	SET SCREW	PT1/4"	2	A123	CONNECTING BOLT		1
A82	OIL PILOT	20M/M	1	A124	HOSE CLAMP		2
A83	LOWER LENGTH SETTING ROD		1	A125	HOSE		1
A84	UPPER LENGTH SETTING ROD		1	A126	VALVE		1
A85	LENGTH SETTING RODS HOLDER		1	A129-1	COOLANT TANK		1
A86	LOCK BOLT WITH KNOB		1	A201	CONTROL WIRE		1
A87	LOCK BOLT WITH KNOB		1	A202	WIRE TERMINAL CLAMP		1
A88	NUT	M12	1	A203	SUPPORT PLATE		1
A89	ANTI-DUST PLATE		1	A204	HEX. CAP SCREW	M6X10	4
A90	HOLDER PLATE		1				
A91	NUT	M12	1				
A92	HEX CAP SCREW		1				
A93	WISE BENCH		1				
A94	SWING ARM (BASE)		1				
A95	PIN	5X14	2				
A96	NUT	M6	1				
A97	SWITCHING SUPPORTER		1				
A98	WISE CLAMP		1				
A100	SUPPORTER		1				
A101	WASHER	5/16"	2				
A102	HEX SOCKET CAP SCREW	M8X20	2				
A103	EMERGENCY SWITCH		1				
A104	START BUTTON		1				
A105	STOP BUTTON		1				
A106	SCREW	M5	4				
A107	SELECT SWITCH		1				
A108	PUMP SELECTION SWITCH		1				
A109	CONTROL PANEL		1				
A110	WASHER	5/16"	2				
A111	HEX SOCKET CAP SCREW	M8X20	2				
A112	ELECTRIC CONTROL BOX		1				
A113	CONTROL BOX BOTTOM PLATE		1				
A114	MAGNETIC CONTACTOR		1				
A115	FUSE SET		1				
A116	COVER PLATE		1				
A117	RELAY		1				
A118	TRANSFORMER		1				
A120	NUT	M20X1.5	1				
A121	PT SCREW		1				
A122-1	COOLANT PUMP		1				

NOTE: SOME INDIVIDUAL PARTS MAY ONLY BE AVAILABLE AS AN ASSEMBLY

WIRING DIAGRAM

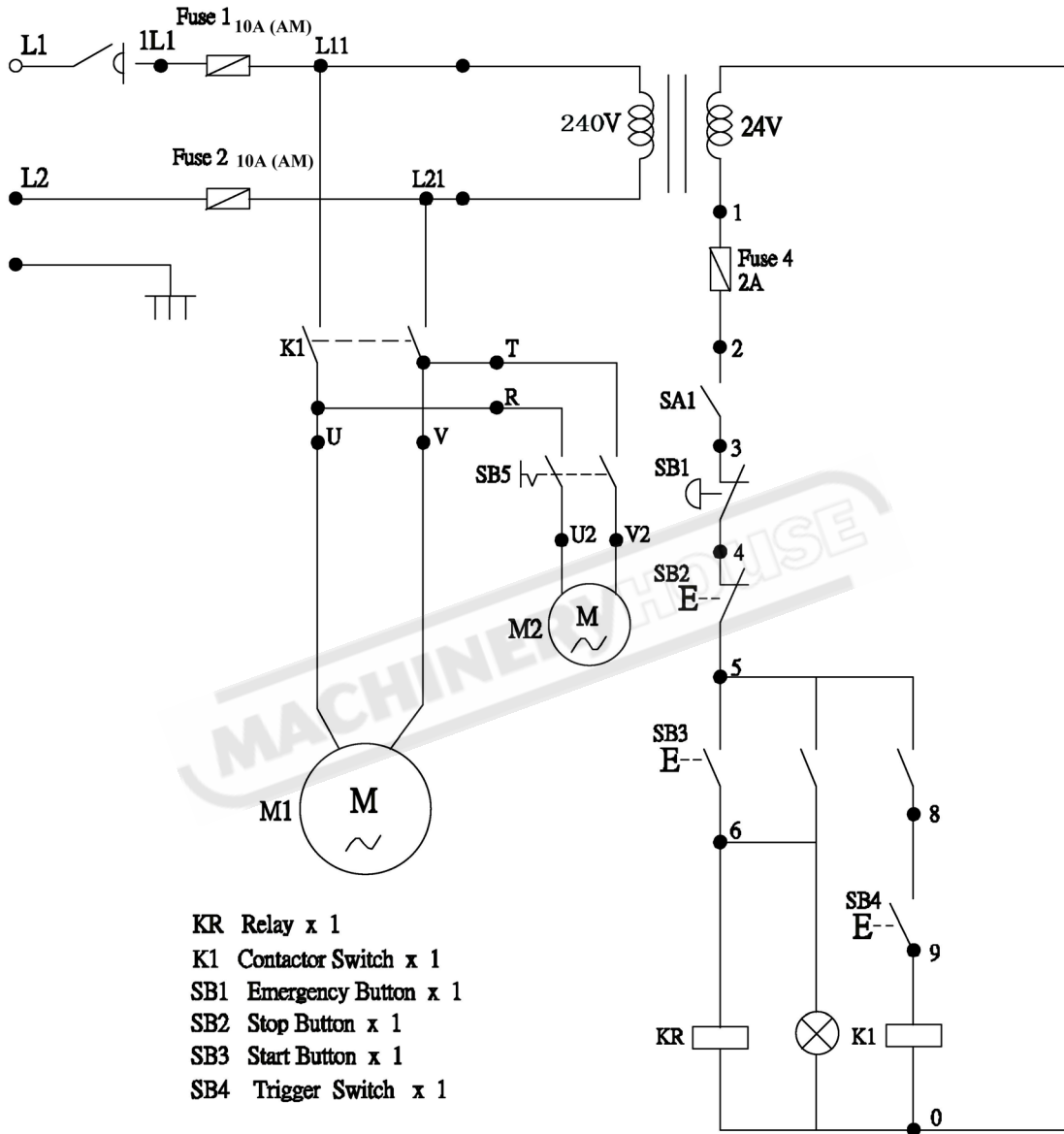

WIRING SPARE PARTS LIST.

Item name	Description and function	Technical data	Quantity	Supplier	Suppliers reference	Remarks
FU1 FU2 FU3	Fuses	10A(T) 10A(T) 2A	1 1 1	JENN FENG	S15A	
	Fuses base	10A 3P	1		FSB-104	CE
K1	Contactors	Coil 24V I _e =25A 220V 2.2kw 400V 4.0kw	1	NHD	C-09D	ICE 158-1 BS 5424-1 VDE 0660 J13 8325
KR	Relay	250VAC 5A	1	SHINOHAWA	MY-2N AC 24V	CE CSA
TC	Transformer	35VA 400/24V	1	JIA LIXIN	57	
SB1	Emergency Stop	250V 6A	1	KEDU	HY57B	CE CUS
SB2 SB3	OFF button Start button	250V 6A	1 1	MAACK	ABF-22Φ 1b ABLFS-22Φ 1a 30V	CE CUS
SB4	Trigger switch	15A 1/2HP 125 250VAC 0.6A 125VDC 0.3A 250VDC	1	OMRON	V-15-1A5	CE CUS
SB5	Pump switch	250V	1	GIKOKA	OSS-22Φ	CE CUS
SA1	Hi/Low speed select switch	440V 5kw	1	KEDU	ZH-HC-5	CE CUS
M1	Motor	220V~240V/ 0.75kw (1HP) 1ph/4P	1	KAI SHEN		
M2	Coolant pump	220~240V / 1ph 0.09kw (1/8HP)	1	KAI SHEN		